

April 2023 Community Meetings: Marked-Up Aerials

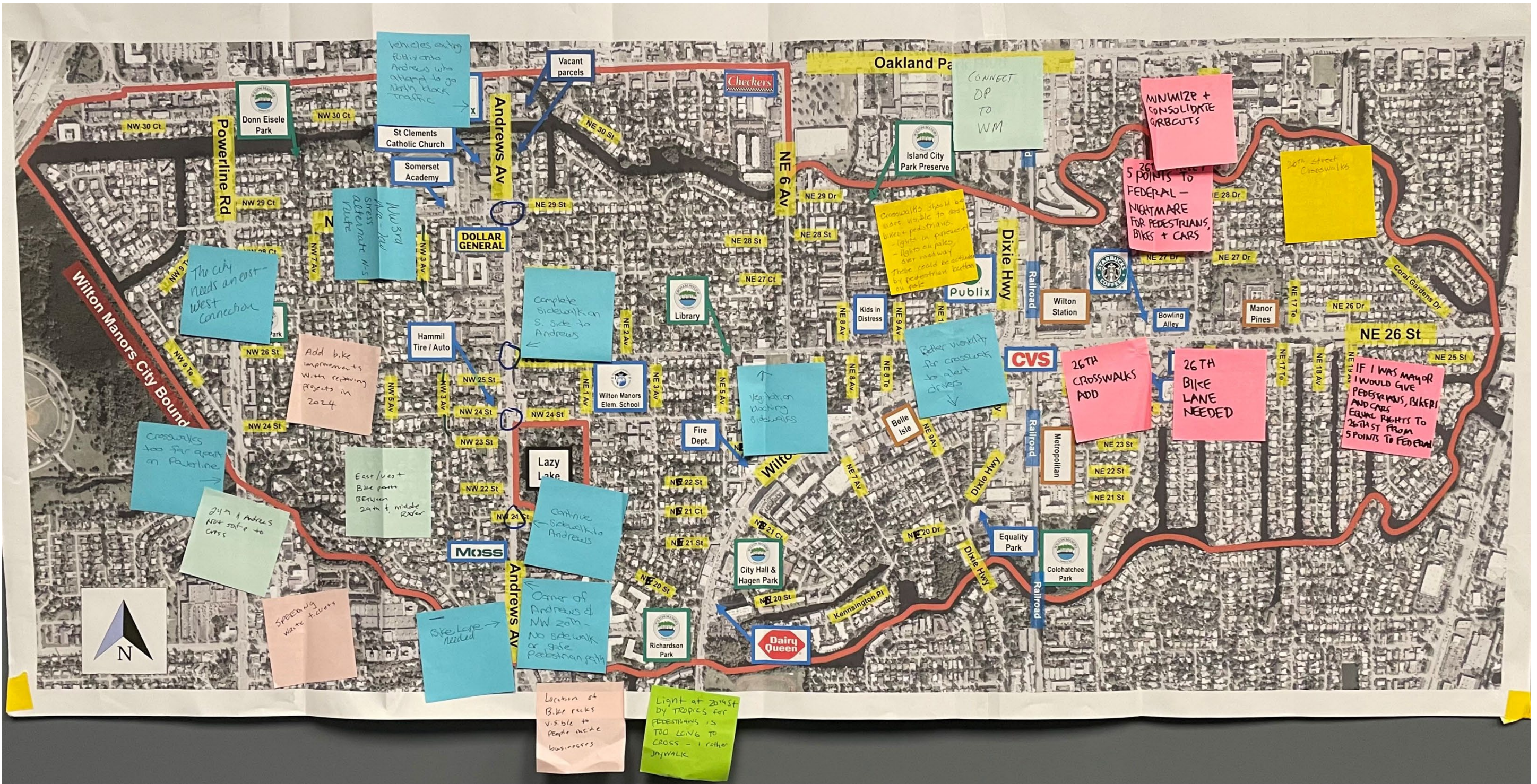

April 2023 Community Meetings: Marked-Up Aerials



April 2023 Community Meetings: Marked-Up Aerials

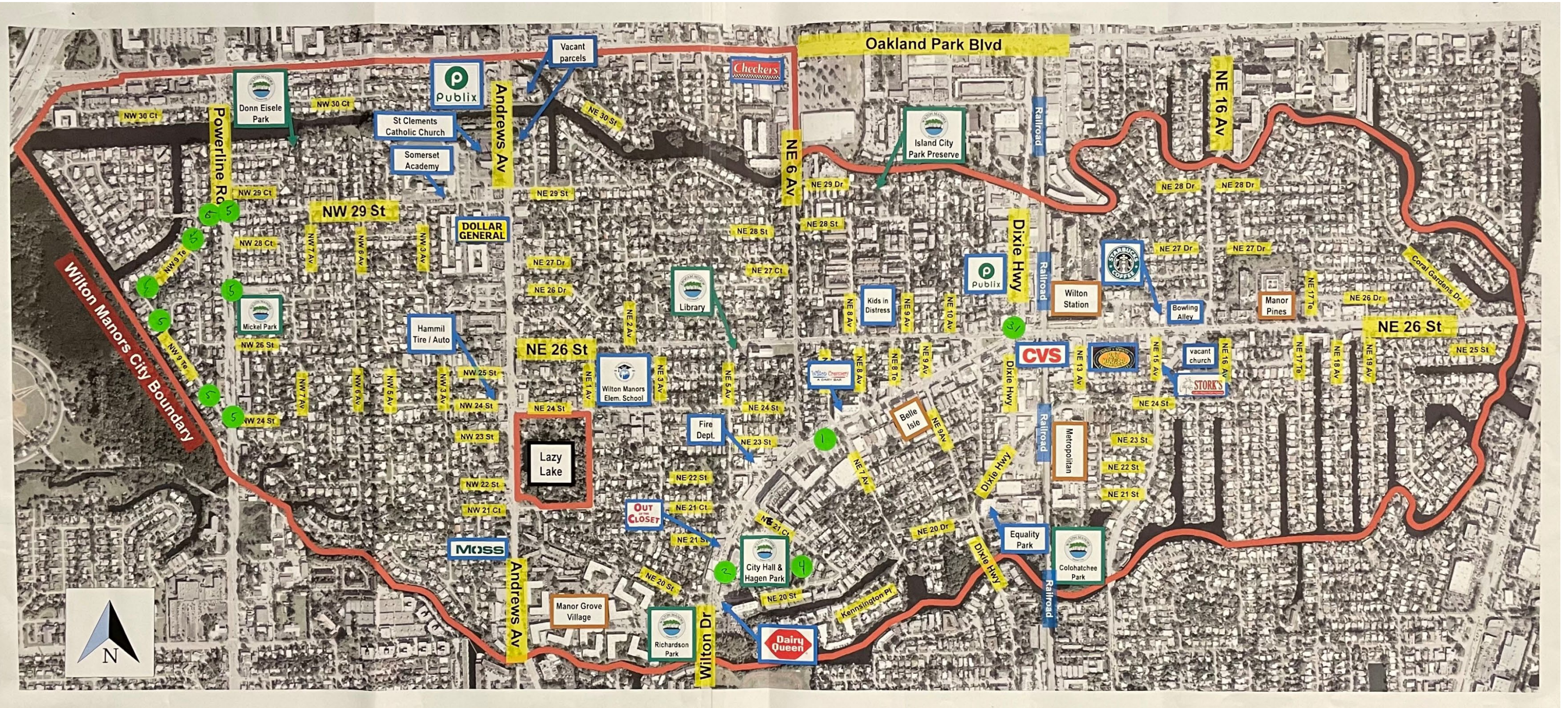

April 2023 Community Meetings: Photos



Community Meetings: Transcribed Comments by Location / Topic

Aerial	Location: Andrews Av	Topic	Comment
Aerial 2	Andrews Av	Bike	Bike lanes needed
Aerial 2	Andrews Av	Bike	Location of Bike racks visible to people inside businesses
Notebook	Andrews Av	Bike	Need protected with a curb bike lane or a shared use path on Andrews Ave
Notebook	Andrews Av	Intersection safety	Intersections are problematic due to off-set / jog in the east-west alignment of roads (e.g. vehicles make illegal left-turn movements from side streets on to Andrews Ave)
Aerial 1	Andrews Av	Lighting	Pedestrian Lighting needed
Notebook	Andrews Av	Misc.	Andrews, 1964 extension, look at history of the road
Notebook	Andrews Av	Misc.	Residents want City to work with Fort Lauderdale since it is mostly residential going south between Sunrise and OPB
Notebook	Andrews Av	Misc.	Residents want Andrews Ave to feel like Wilton Drive as a "Main St"
Notebook	Andrews Av	Pedestrian	There are no lights on Andrews (meant pedestrian lights)
Aerial 3	Andrews Av	Pedestrian/Crosswalk	LED illuminated crosswalks needed
Notebook	Andrews Av	Pedestrian/Crosswalk	No crosswalks / pedestrians do not feel safe on segments or at intersections
Notebook	Andrews Av	Priority	Answer to "If they were mayor, two roadways they would fix"
Notebook	Andrews Av	Priority	Answer to "If they were mayor, two roadways they would fix"
Notebook	Andrews Av	Priority	Answer to "If they were mayor, two roadways they would fix"
Notebook	Andrews Av	Priority	Answer to "If they were mayor, two roadways they would fix"
Notebook	Andrews Av	Priority	Answer to "If they were mayor, two roadways they would fix"
Notebook	Andrews Av	Priority	Answer to "If they were mayor, two roadways they would fix"
Notebook	Andrews Av	Priority	Answer to "If they were mayor, two roadways they would fix"
Notebook	Andrews Av	Priority	Answer to "If they were mayor, two roadways they would fix" (#1)
Notebook	Andrews Av	Priority	Answer to "If they were mayor, two roadways they would fix" (#1)
Notebook	Andrews Av	Priority, Connectivity	Intersection 21 st is preferred route and must be shared use path
Aerial 1	Andrews Av	Speeding	Speed / dangerous = Curve south of NW 21 Ct
Aerial 1	Andrews Av	Speeding	Speed / dangerous = Hill between NE 24 St and NE 21 Ct
Aerial 3	Andrews Av	Speeding	Designed to allow for fast traffic
Notebook	Andrews Av	Speeding	Speeding (Powerline Rd too)
Notebook	Andrews Av	Speeding	Traffic speed
Aerial 2	Andrews Av	Vehicular	Vehicles exiting Publix onto Andrews who attempt to go North block traffic
Notebook	Andrews Av	Vehicular	Pavement markings are faded / nonexistent
Notebook	Andrews Av (Intersection @ NE 24 St	Misc.	24 th ST not used, Old School route
Aerial 2	Andrews Av (Intersection @ NE 24 St	Pedestrian	Not safe to cross
Notebook	Andrews Av (Intersection @ NE 24 St	Pedestrian/Crosswalk	Would like better crosswalk
Aerial 1	Andrews Av (Intersection @ NE 24 St	Sidewalk	Zig zag sidewalk
Notebook	Andrews Av (Intersection @ NE 24 St	Signals	Light not triggered
Notebook	Andrews Av (Intersection @ NE 26 St	Crosswalk	No crosswalk
Notebook	Andrews Av (Intersection @ NE 26 St	Misc.	County plan
Aerial 2	Andrews Av (Intersection @ NW 20 St	Pedestrian/Sidewalk	Corner of Andrews and NW 20 th – no sidewalk or safe pedestrian path
Aerial 1	Andrews Av (Intersection @ NW 21 Ct	Sidewalk	No sidewalk on one side
Notebook	Andrews Av (Intersection @ NW 25 St	Vehicular	Right only but can't make right turns
Aerial 3	Andrews Av (Intersection @ NW 29 St	Vehicular	Cars run red light
Notebook	Andrews Av (Intersection @ NW 29 St	Vehicular	Running light
Notebook	Andrews Av (Intersection @ NW 29 St	Vehicular	too much space between sign and light causing issues; "Stop on Red"; Can you move light back to Stop Point; Cars N/S on Andrews run light; Cause Crossing issues. Sign and signal light obstruction
Summary	<ul style="list-style-type: none"> • Number of comments 43 • List of intersections: NE 24th St, NE 26th St, NW 20th St, NW 21st Ct, NW 25th St, NW 29th St • Most common topics: Priority, pedestrian/crosswalk, intersection safety • Overall summary: Andrews Ave should be a priority roadway. There are lack of crosswalks and intersection safety concerns for pedestrians. 		

Community Meetings: Transcribed Comments by Location / Topic

Aerial	Location: Dixie Highway	Topic	Comment
Aerial 1	Dixie Hwy	Bike	They feel like it is slowed down but still rides bike on sidewalks
Aerial 2	Dixie Hwy	Crosswalk	Better visibility for crosswalk to alert drivers
Notebook	Dixie Hwy	Intersection safety	Curve at equality park is dangerous
Aerial 1	Dixie Hwy	Misc.	Has great continuous flow in Ft Laud
Aerial 3	Dixie Hwy	Parking	Not enough parking
Aerial 2	Dixie Hwy	Pedestrian/Crosswalk	Crosswalks should be more visible to cars, bikes, and pedestrians. Lights in pavement, lights on poles over roadway. These could be activated by pedestrian button on pole.
Notebook	Dixie Hwy	Pedestrian/Crosswalk	Flashing RRFB by Senior center
Notebook	Dixie Hwy	Priority	Answer to "If they were mayor, two roadways they would fix"
Notebook	Dixie Hwy	Priority	Answer to "If they were mayor, two roadways they would fix"
Notebook	Dixie Hwy	Safety	Increasingly dangerous
Notebook	Dixie Hwy	Safety	(from bridge to bridge) is unsafe for all – vehicles, pedestrians, bicyclists (hard to backout of businesses, not space for pedestrians and bicyclists / also area gets congested with long freight trains.
Aerial 1	Dixie Hwy (Intersection @ 5-Points	Signals	5 points timing
Aerial 3	Dixie Hwy (Intersection @ NE 24 St	Lighting	Good connection, not well lit connection to drive
Aerial 1	Dixie Hwy (Intersection @ NE 24 St)	Safety	They use the pedestrian access at the parking lot at Dixie Hwy and NE 24 St to walk to Wilton Dr
Mayor Map	Dixie Hwy (Intersection @ NE 26 St	Intersection safety	(31) 5 points railroad needs to be elevated so traffic is not affected. 5 points needs to be painted and marked well for each direction
Summary	<ul style="list-style-type: none"> • Number of comments 15 • List of intersections: 5 points, NE 24th St, NE 26th St • Most common topics: Safety, Pedestrian • Overall summary: There are several safety comments. There are crosswalk needs and pedestrian safety issues. 		

Community Meetings: Transcribed Comments by Location / Topic

Aerial	Location: NE 26 St	Topic	Comment
Aerial 2	NE 26 St	Bike	Bike lane needed
Notebook	NE 26 St	Bike	Use this road for leisure bike rides
Notebook	NE 26 St	Bike, Connectivity	Wants bike / walk route to 7-11 on NE 15 Av
Aerial 2	NE 26 St	Bike/Pedestrian safety	If I was mayor I would give pedestrians, bikers, and cars equal rights to 26 th St from 5 points to Federal
Mayor Map	NE 26 St	Congestion	(3 not on map) By narrowing Wilton Dr, this dumped all traffic on to NE 26 St, which is packed now. NE 6th Ave is hard to make a left at NE 26th St because traffic on 6th is crowded
Aerial 2	NE 26 St	Crosswalk	Add crosswalks
Aerial 2	NE 26 St	Crosswalk	Crosswalks
Aerial 3	NE 26 St	Crosswalk	Need a crosswalk on from 26 th Wilton Station to Storks
Notebook	NE 26 St	Crosswalk	Crosswalks needed behind Rosie's to go to Publix
Notebook	NE 26 St	Crosswalk	Crosswalks needed from Starbucks to Storks
Aerial 3	NE 26 St	Lighting	Need better pedestrian lighting
Aerial 1	NE 26 St	Pedestrian	Jaywalking near Starbucks
Aerial 2	NE 26 St	Pedestrian/Bike safety, Vehicular	5 points to federal – nightmare for pedestrians, bikes, and cars
Aerial 1	NE 26 St	Pedestrian/Crosswalk, Connectivity	To walk from the Coral Gardens neighborhood to Wilton Dr, they cross at either NE 16 Av or NE 17 Te (and walk along NE 24 St); They would like crosswalks at both locations
Notebook	NE 26 St	Priority	Answer to "If they were mayor, two roadways they would fix"
Notebook	NE 26 St	Priority	Answer to "If they were mayor, two roadways they would fix"
Notebook	NE 26 St	Priority	Answer to "If they were mayor, two roadways they would fix"
Aerial 1	NE 26 St	Safety, Shade, Speeding	Curb cuts, shade, speed
Aerial 3	NE 26 St	Shade	No shade
Notebook	NE 26 St	Shade	Very hot
Aerial 3	NE 26 St	Signals	Pedestrian signal not long enough at 5 points
Aerial 2	NE 26 St	Vehicular	Minimize and consolidate curb cuts
Aerial 3	NE 26 St	Vehicular	Cars are using the extra area (not a travel lane) to drive in
Notebook	NE 26 St (5-Points east)	Bike/Pedestrian	Not walkable or bikeable
Notebook	NE 26 St (5-Points east)	Bike/Pedestrian/Safety	Road should be designed for all ages and abilities (noted many senior living facilities and motorized mobility scooter / wheelchair and other accessibility devices are used on roadway)
Notebook	NE 26 St (5-Points east)	Priority	Answer to "If they were mayor, two roadways they would fix"
Notebook	NE 26 St (5-Points east)	Priority	Answer to "If they were mayor, two roadways they would fix"
Notebook	NE 26 St (5-Points east)	Safety	Too many curb-cuts / eliminate them and install landscaping
Notebook	NE 26 St (5-Points east)	Safety, Vehicular	Hard to back-out of driveways
Notebook	NE 26 St (5-Points east)	Shade	Needs shade trees (e.g., Live Oak trees)
Notebook	NE 26 St (Intersection @ 5-Points)	Misc	Make 5-Points better
Notebook	NE 26 St (Intersection @ 5-Points)	Vehicular, Traffic Calming	Not a roundabout at 5-points
Aerial 2	NE 26 St (Intersection @ Andrews Av)	Sidewalk	Complete sidewalks on South side to Andrews
Aerial 2	NE 26 St (Intersection @ NE 6 Ave)	Pedestrian/Sidewalk	Vegetation blocking sidewalks
Aerial 3	NE 26 St (Intersection @ NE 8 Av)	Lighting	Parking lot is not well lit
Summary	<ul style="list-style-type: none"> • Number of comments 35 • List of intersections: 5 Points (east, Andrews Ave, NE 6th Ave, NE 8th Ave) • Most common topics: Priority, Shade, Pedestrian • Overall summary: A lot of pedestrian safety concerns and crosswalk needs,. NE 26th St is lacking shade and should be a priority roadway 		

Community Meetings: Transcribed Comments by Location / Topic

Aerial	Location: Powerline Rd	Topic	Comment
Aerial 3	Powerline Rd	Crosswalk	Crosswalks need to be more prominent
Aerial 3	Powerline Rd	Crosswalk, Connectivity	Crosswalk needed to connect to Mickel Park
Notebook	Powerline Rd	Intersection Safety	Need to focus on intersections
Aerial 2	Powerline Rd	Misc	The city needs an East West road
Notebook	Powerline Rd	Pedestrian	Have a designated pedestrian-only cross time over Powerline Rd
Aerial 2	Powerline Rd	Pedestrian/Crosswalk	Crosswalks too far apart
Aerial 3	Powerline Rd	Pedestrian/Crosswalk	LED illuminated crosswalks needed
Notebook	Powerline Rd	Pedestrian/Crosswalk	Upgrade existing crosswalk with RRFB
Notebook	Powerline Rd	Pedestrian/Crosswalk, Connectivity	Need crosswalk by Mickel Park with a signal
Notebook	Powerline Rd	Pedestrian/Crosswalk, Connectivity	Crosswalks needed leading to Mickel,
Notebook	Powerline Rd	Priority	Answer to "If they were mayor, two roadways they would fix"
Notebook	Powerline Rd	Safety	Most pedestrian deaths on Powerline are children
Aerial 2	Powerline Rd	Speeding	Speeding write tickets
Notebook	Powerline Rd	Vehicular	Powerline redesigned as a residential road. Need short term solutions
Notebook	Powerline Rd	Vehicular	Powerline was a test, FDOT never came back for a Permanent installation
Aerial 1	Powerline Rd (Intersection @ NW 25 Ct	Bike	Bike lanes end
Aerial 1	Powerline Rd (Intersection @ NW 29 St	Bike	New bike lane on NW 29 th St will end at intersection
Notebook	Powerline Rd (Intersection @ NW 29 St	Crosswalk	Crosswalks need to be upgraded
Aerial 3	Powerline Rd (Intersection @ NW 29 St	Pedestrian/Intersection Safety	Crossing concerns at this intersection
Notebook	Powerline Rd (Intersection @ NW 9 Te	Bike	Need curb / landscape island between vehicle lane and bike lane (Vehicles use the marked buffer and bike lane to pass other vehicles)
Aerial 3	Powerline Rd (Intersection @ NW 9 Te	Pedestrian	A lot of jaywalking
Mayor Map	Powerline Rd (Intersection @ NW 9 Te	Speeding, Traffic Calming	(5) Speed bumps or beds to slowdown traffic on Powerline Rd
Summary	<ul style="list-style-type: none"> • Number of comments 22 • List of intersections: NW 25th Ct, NW 29th St, NW 9th Terr • Most common topics: Pedestrian, Crosswalk • Overall summary: There should be better connectivity to Mickel Park. There are a lot of pedestrian safety/crosswalk needs. 		

Community Meetings: Transcribed Comments by Location / Topic

Aerial	Location: Wilton Dr	Topic	Comment
Aerial 3	Wilton Dr	Crosswalk	Crosswalk locations are not in the right location
Notebook	Wilton Dr	Crosswalk	Crosswalk locations
Mayor Map	Wilton Dr	Misc	(2) Hagen Park parking lot should not face Wilton Drive, should be park land
Mayor Map	Wilton Dr	Parking	(1) Remove all parking lots on Wilton Drive, build hidden garages
Aerial 3	Wilton Dr	Pedestrian	A lot of Jaywalking
Notebook	Wilton Dr	Pedestrian	Jaywalking
Notebook	Wilton Dr	Pedestrian/Safety	Vehicles don't yield to pedestrians at intersections and at crosswalks – especially the one in front of Bona restaurant (NE 11 Ave) - (residents suggested speed bump or raised crosswalk, improved pedestrian lighting, in-road lighting)
Notebook	Wilton Dr	Safety	Remove bus turnouts (bus bays)– vehicles use them to pass other vehicles making it dangerous for bicyclists and pedestrians
Notebook	Wilton Dr	Signals	Ped “WALK” signals take too long / most people jaywalk or cross the street on “red” due to long vehicle green signal – Wilton Drive signals should be prioritized for pedestrians, not vehicles.
Aerial 3	Wilton Dr	Speeding	Cars drive too fast
Notebook	Wilton Dr	Speeding	Cars driving too fast
Notebook	Wilton Dr	Speeding, Traffic Calming	Slow down traffic
Notebook	Wilton Dr	Speeding, Traffic Calming	Vehicles still speed on The Drive (e.g., need additional speed management countermeasures)
Mayor Map	Wilton Dr (at City Hall / Hagen Park)	Bike/Pedestrian, Wayfinding	(4) A detailed bike map/pedestrian walk as a tour of the city with featured stops at the parks. A bike tour path through all the parks. Tourist will love it too!
Notebook	Wilton Dr (Belle Isle to 5-Points)	Priority	Answer to “If they were mayor, two roadways they would fix”
Aerial 2	Wilton Dr (Intersection @ NE 20 St	Signals	Light at 20 th St by Tropics for pedestrians is too long to cross, I rather jaywalk
Notebook	Wilton Dr (Intersection @ NE 20 St	Signals	Signal is too long for pedestrians
Notebook	Wilton Dr (Intersection @ NW 7 Av	Crosswalk	Crosswalks needed
Summary	<ul style="list-style-type: none"> • Number of comments 18 • List of intersections: City Hall, Belle Isle to 5 points, NE 20th St, NW 7th Ave • Most common topics: Pedestrian, Crosswalk, Signals • Overall summary: There is a lot of jaywalking, due to crosswalk placement. Signals take too long. 		

Community Meetings: Transcribed Comments by Location / Topic

Aerial	Location: Misc.	Topic	Comment
Aerial 3	NE 11 Av	Positive, Connectivity	Connects Wilton Drive and Dixie
Notebook	NE 15 Av	Bike / Ped Safety	Remove bus turnouts (bus bays)– vehicles use them to pass other vehicles making it dangerous for bicyclists and pedestrians
Aerial 1	NE 15 Av	Positive	Like 15 th raised intersections
Aerial 3	NE 20 Dr (Intersection @ NE 7 Av)	Vehicular	Cars don't stop at stop signs
Notebook	NE 21 Ct	Priority	Answer to "If they were mayor, two roadways they would fix" (Both NW and NE 21 Ct)
Aerials	NE 21 Ct	Sidewalk	No sidewalk on southside
Notebook	NE 21 Ct	Sidewalk	Fill in sidewalk gaps on the south side.
Notebook	NE 24 St	Connectivity	Takes NE 24 th St to Wilton Dr
Notebook	NE 6 Av	Vehicular	Heavy Trucks use road, even though they are prohibited
Notebook	NE 6 Av (Intersection @ OP Blvd)	Signals	Needs flashing yellow for turn, not red. And longer green
Notebook	NE 7 Av	Vehicular, Cut through traffic	A lot of cut through traffic and concerned there will be more
Aerial 2	NW 24 Ct	Sidewalk	Continue sidewalks to Andrews
Notebook	NW 29 St	Congestion, Vehicular	A lot of east / west roads were closed and pushes everyone onto 29th (same as Andrews)
Notebook	NW 29 St	Sidewalk	Sidewalk issues
Aerial 2	NW 3 Av	Bike/Pedestrian, Connectivity	Low stress alternate N-S bike / ped route
Notebook	NW 9 Te	Speeding, Vehicular, Cut through traffic	A lot of cut through traffic and are speeding; Also there is no left turn onto 9th from Powerline
Summary	<ul style="list-style-type: none"> • Number of comments 16 • Locations: NE 15 Av; NE 21 Ct; NE 6 Av; NW 29 St • Overall summary: There are a lot of sidewalk gaps/needs. Due to vehicles speeding, there are bike/ped safety concerns 		

Community Meetings: Transcribed Comments by Location / Topic

Aerial	General Comments	Comment
Aerial 1	General	Like streetscape of NE 13 th St in Ft Laud
Notebook	General	Be mindful of the city demographics
Notebook	General	I'm on a cul-de-sac and LIFT, UBER drivers go fast
Notebook	General	Landscaping to slow folks
Notebook	General	Narrow lane to slow
Notebook	General	Overpass for trains
Notebook	General	Passing on marked areas
Notebook	General	Seem to prefer essential destination
Notebook	General	This is a neighborhood. Who cares about one pass through. This is "our" home.
Notebook	General	Train traffic is an increasing issue
Notebook	General	WM is a pass-through city
Notebook	General	Works for city
Notebook	General	Residents stated all of the bridges into WM are too dangerous to cross for pedestrian and bicyclists.
Notebook	General	Circuit should not use bike lanes as drop off – City should make them stop in traffic lanes to let people out, use side streets or designate drop-off locations.
Notebook	General	Code enforcement needs to make sure all sidewalks are clear (a lot of vegetation and vehicles block sidewalks)
Notebook	General	Trees – residents feel the existing roads city-wide are too wide and need to be narrow and replace concrete with grass and trees for shade (Live Oaks)
Notebook	General	Prohibit truck through traffic on residential streets (residents said semitrucks cut-through neighborhood streets to avoid Sunrise, US1, & OPB) – including: NW 29 St from Powerline to Andrews; NE 26 St from Andrews to 5-Points; NE 15 & 16 Aves; NE 24 St; NE 20 St
Notebook	General	West side neighborhood survey resulted in high number of people want more street lighting.
Notebook	General	Residents provided examples of walkable areas: Cleveland Heights, OH and Golden Beach, FL – speed management (residents said that when you enter Golden Beach, vehicles slow down because they know the City is strict on speeding)
Notebook	General	Recommended engaging directly with business / tourism community: Wilton Drive Improvement District and LGBTQ+ Business Coalition (wiltondrivevoice.com / https://infiniteunitypride.org) Jude Belanger is the contact and on WM P&Z Board
Aerial 2	General - Bike	Add bike improvements with repaving projects in 2024
Aerial 3	General - Bike	The city needs more bike racks
Notebook	General - Bike	Bike lanes are dangerous, likes the shared use path idea
Notebook	General - Bike	Bike on NE 24 th Street Coral Gardens
Notebook	General - Bike	Fun to bump around the parks – Bike Tour
Notebook	General - Bike	Only rides his bike on sidewalks
Notebook	General - Bike	Ride on low stress routes, neighborhood streets
Notebook	General - Bike	Wish I could bike, west side resident, I would ride to the beach
Notebook	General - Bike	Need designated bike route with signage and map throughout the city.
Notebook	General - Bike	Bike racks should be in front of business within eye-view of people inside businesses (now, the bike racks are in the back of business behind dumpster where it makes it less visible and easier for theft)
Notebook	General - Route	West route to Wilton Dr = Answer to "If they were mayor, two roadways they would fix"
Notebook	General - Route	East route to Wilton Dr = Answer to "If they were mayor, two roadways they would fix"
Aerial 2	General - Route	Need East West bike paths in between NW 29 St and the Middle River
Aerial 2	General - Route	Connect Oakland Park to Wilton Manors
Notebook	General - Route	Publix access critical to any plan
Notebook	General - Route	Would like a path from Jenada Isle to City Hall
Notebook	General - Route	Would like a path from Mickel Park to Hagen Park
Notebook	General - Route	Would like to be able to walk to Publix and CVS
Notebook	General - Route	Want better ways for pedestrians and bicyclists to reach destinations in Oakland Park, Fort Lauderdale (downtown), and beaches. Also, make better east / west connections from Powerline to Andrews via NW 26 St and / or NW 21 Ct. Residents said it is difficult since there is no direct connection south of NW 29th St.
Notebook	General - Route	Island City park Preserve - Add a pedestrian / bicycle bridge to connect to OP's BLYS boardwalk along the Middle River
Notebook	General - Route	Would like a path from Mickel Park to 5-Points
Summary		<ul style="list-style-type: none"> • Number of comments 41 • Most common topics: Bike facilities; Routes • Overall summary: More off-street bike improvements are needed, additional bike racks are needed, cut through traffic is an ongoing issue

Wilton Manors - Community Meeting - 4/1^a/2023 (Afternoon)

SIGN-IN SHEET

NAME - Please Print	Resident	Other	City / Zip Code	EMAIL <i>(if you want to keep in touch)</i>
Mark Thomas	✓		33311	markandoz@yahoo.com
Orville Bradley	✓		33311	ozandmark@yahoo.com
FRANK SWEET	✓		33305	FRANKSWEET@MSN.COM
HUNTER STEPHENS	✓		33311	DHSDC@ME.COM
Bert Fisher		✓	33305	bfisher@wiltonmanors.com
LARRY FISCHER	✓		33305	LF, FISCHER, S@GMAIL.COM
Lisa Thersen	✓		33311	
Tim Thersen	✓		33311	
Joey Wynn	✓		33311-5308	Joey.Wynn254@gmail.com
GEORGE DEFRANCE	✓		33311	CYHORACE@COMCAST.NET

Wilton Manors - Community Meeting - 4/24/2023 (Evening)
SIGN-IN SHEET

NAME - Please Print	Resident	Other	City / Zip Code	EMAIL (if you want to keep in touch)
JONATHAN GRAF	✓		WILTON MANORS, 33334	You GOT ME
Shawn + Mark Hall	✓		" " "	
PAUL A. KUTA	✓		WILTON MANORS 33334	NONE
JAIMIE TRUJILLO	✓		Wilton Manors 33334	JaimiegatsMAIL@GMAIL.COM
Van Gosselin	✓		Wilton Manor 33311	VGOSSELIN@comcast.net
Shawn Walsh	✓		Wilton Manors 33311	me@shawnwalsh.com
DAVID BRASSIL	✓		Wilton Manors, 33311	dtbrassil@gmail.com
Beatriz Sclere Diaz Dovia	✓		Wilton Manors 33311	BSDD32@gmail.com
RAY CARRIER	✓		WILTON 33305	RAY@NYKY.ORG
Glen Weinzimer		✓	Wilton Manors 33302	Glen@PoseeHelicopters.org
PAUL KOLL	✓		Wilton MANORS 33303	
* Lynne Buehner	✓		Wilton Manors 33305	SRHL2301@comcast.net
Robert Hadley	✓		WM 33305	RIHADLEY@comcast.net
Don D'Armino	✓			DonD'Armino@yahoo.com
Chris Baylan	✓		WM 33311	wiltonmanors@chrisbaylan.com

Wilton Manors - Community Meeting - 4/24/2023 (Evening)
SIGN-IN SHEET

NAME - Please Print	Resident	Other	City / Zip Code	EMAIL <i>(if you want to keep in touch)</i>
Jude Belanger ^{Wilton Drive} Voice	X	WDPV	33334	MJudebelanger@gmail.com
John Valeri			33311	
Sharon Kerwick	X	Bus	33305	Sharon@Kerwick.com
Lawrence Farver	X		33311	LAWRENCEWAYNE FARVER@Gmail.com