



Move People & Goods | Create Jobs | Strengthen Communities

# City of Plantation

## Multimodal Master Transportation Plan: Phase 2

Plantation Midtown Advisory Board Meeting

March 16, 2023

# MMTP Phases

## Phase 1: Short-term Improvements

- Themes: Safety, Traffic Calming, Midtown Connectivity
- Focused on eight city-owned roadways
- ✓ Report complete in Summer 2022

## Phase 2: Mid/Long-term Improvements

- Themes: Connectivity and Strategic
- Focused on two corridors (Cleary Blvd and University Dr)

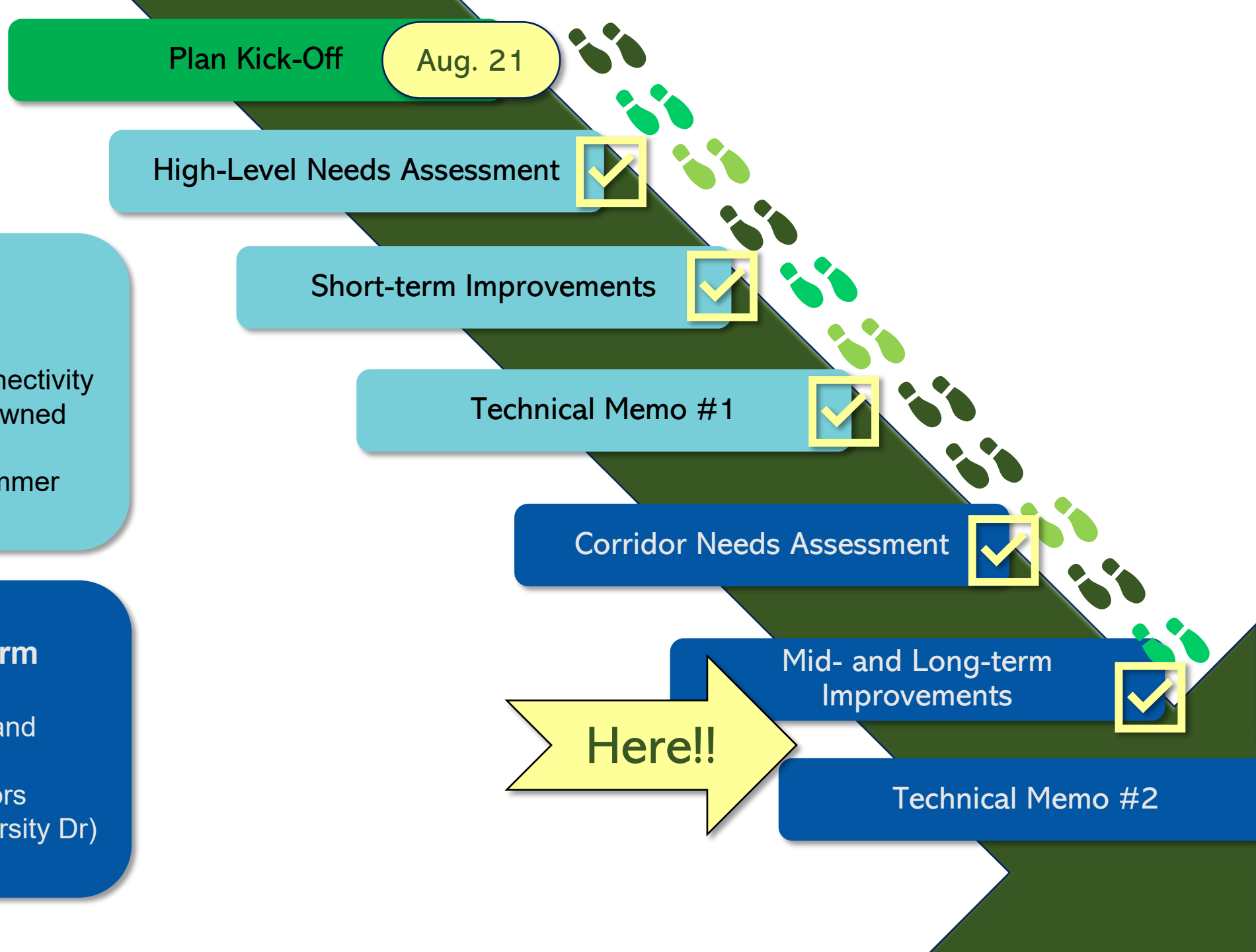

# MMTP Phase 2: Focus Corridors

## Cleary Blvd, from University Dr to Hiatus Rd Greenway

### Connectivity

- ✓ Connect to Greenway, Parks, School, neighborhood commercial
- ✓ E/W corridor-wide connectivity
- ✓ Connect *Into / Via* Midtown

### Strategic

- ✓ Funding Opportunities due to project scale and scope
- ✓ Private Investment / redevelopment at Midtown
- ✓ Partnerships with FDOT and Broward County

## University Dr, from Broward Blvd to Sunrise Blvd

### Connectivity

- ✓ Connect neighborhoods east and west of University Dr
- ✓ Connect to Veterans Park, Marciano Estates Park, City Hall, MURP, Central Park
- ✓ Connect *Into / Across / Via* Midtown

### Strategic

- ✓ High-crash intersections
- ✓ Funding Opportunities due to project scale and scope
- ✓ Private Investment / redevelopment at Sunrise Blvd
- ✓ Private Investment / redevelopment at Midtown
- ✓ Partnerships with FDOT and Broward County
- ✓ Future partnership with City of Sunrise

### Legend

- Plantation GIS Data
- Roadways\_Jurisdiction
  - CITY
  - FDOT
  - COUNTY
- BC\_City\_Boundaries

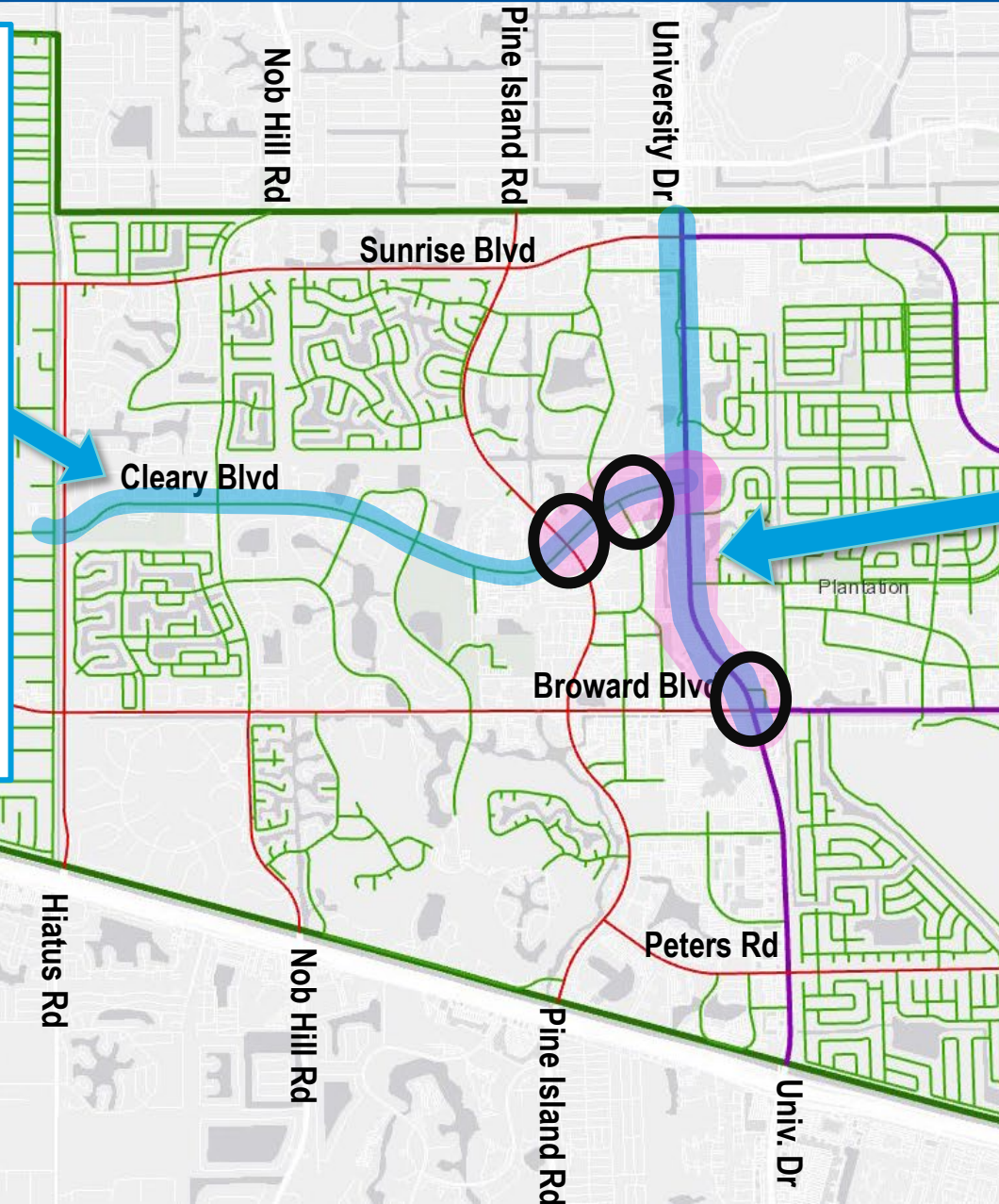

# University Drive: Final Recommendations

**Sunrise Blvd:**  
 Ped Light; Ped Signal Improvements;  
 Tighten Curb Radii; Extend Medians; Ped  
 Refuge Islands; Request FDOT identify  
 improvements to reduce excessive nighttime  
 crashes

**Access Rd:**  
 Reduce lane width; Expand Pedestrian  
 space; Ped Lighting; Raised Crosswalks;  
 Connectivity to N and S Marcano

**S. Marcano Blvd:**  
 Full signalization; Ped Light; Connections to  
 sidewalks on Access Rd and NW 79 Te

Reduce Speed Limit to 40 MPH  
 (same as south of Cleary BI)

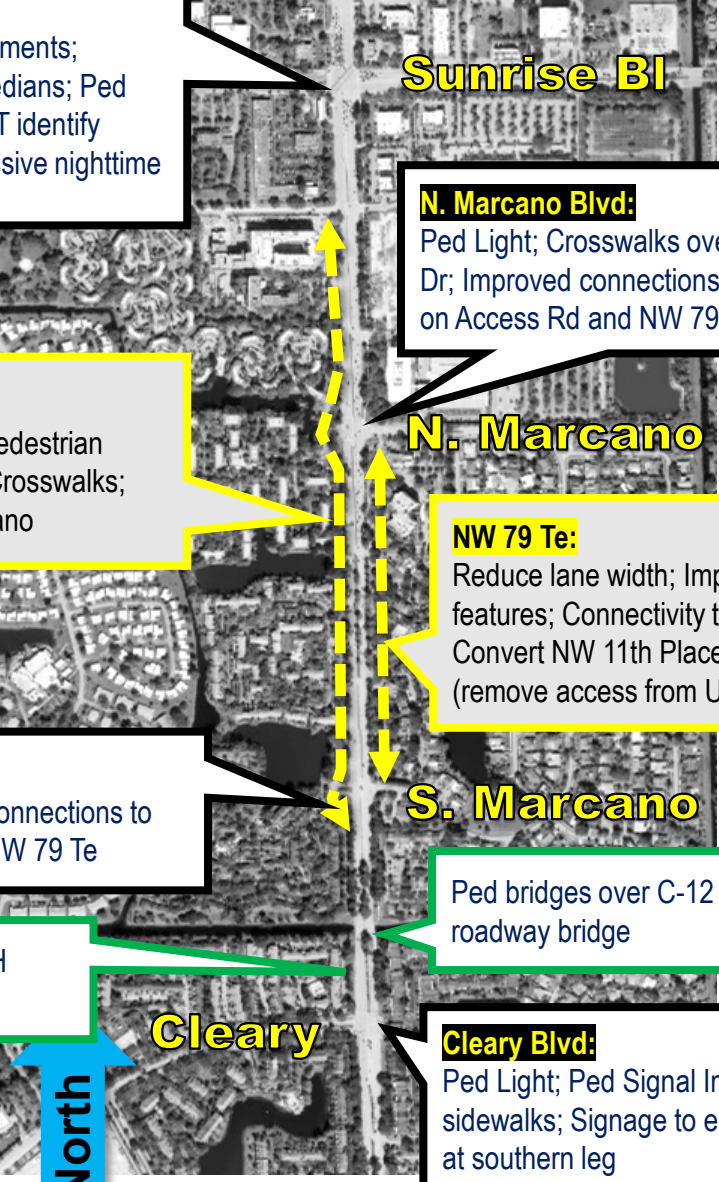

**Sunrise BI**

**N. Marcano Blvd:**  
 Ped Light; Crosswalks over University  
 Dr; Improved connections to sidewalks  
 on Access Rd and NW 79 Te

**N. Marcano**

**NW 79 Te:**  
 Reduce lane width; Improve Pedestrian  
 features; Connectivity to N and S Marcano;  
 Convert NW 11th Place to right-out only  
 (remove access from University Dr)

**S. Marcano**

Ped bridges over C-12 canal, parallel to  
 roadway bridge

**Cleary Blvd:**  
 Ped Light; Ped Signal Improvements; Widen  
 sidewalks; Signage to encourage crosswalks  
 at southern leg

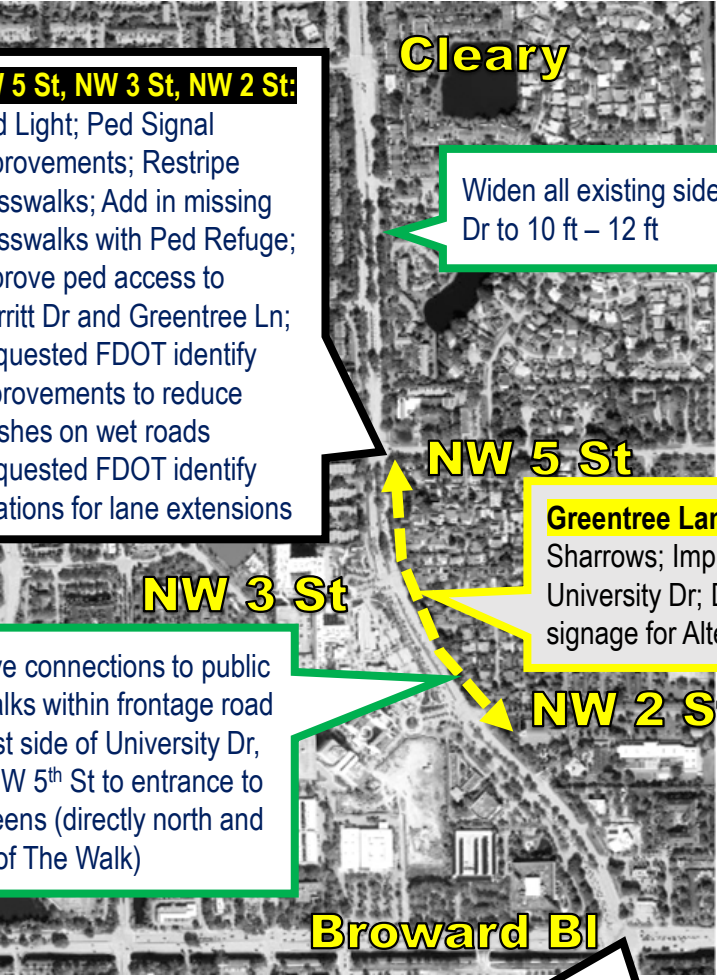

**NW 5 St, NW 3 St, NW 2 St:**  
 Ped Light; Ped Signal  
 Improvements; Restripe  
 crosswalks; Add in missing  
 crosswalks with Ped Refuge;  
 Improve ped access to  
 Merritt Dr and Greentree Ln;  
 Requested FDOT identify  
 improvements to reduce  
 crashes on wet roads  
 Requested FDOT identify  
 locations for lane extensions

Widen all existing sidewalks along University  
 Dr to 10 ft – 12 ft

**NW 5 St**

**Greentree Lane**  
 Sharrows; Improved Ped Access from  
 University Dr; Designate / provide  
 signage for Alternate Bike Route

Improve connections to public  
 sidewalks within frontage road  
 on west side of University Dr,  
 from NW 5<sup>th</sup> St to entrance to  
 Walgreens (directly north and  
 south of The Walk)

**NW 2 St**

**Broward BI**

**Broward Blvd:** Enclose canal; Ped Bridge;  
 Fencing in medians; Widened crosswalks;  
 Porkchop with raised crosswalk in SE corner;  
 Design porkchop with mountable curb

# Cleary Blvd: Final Recommendations

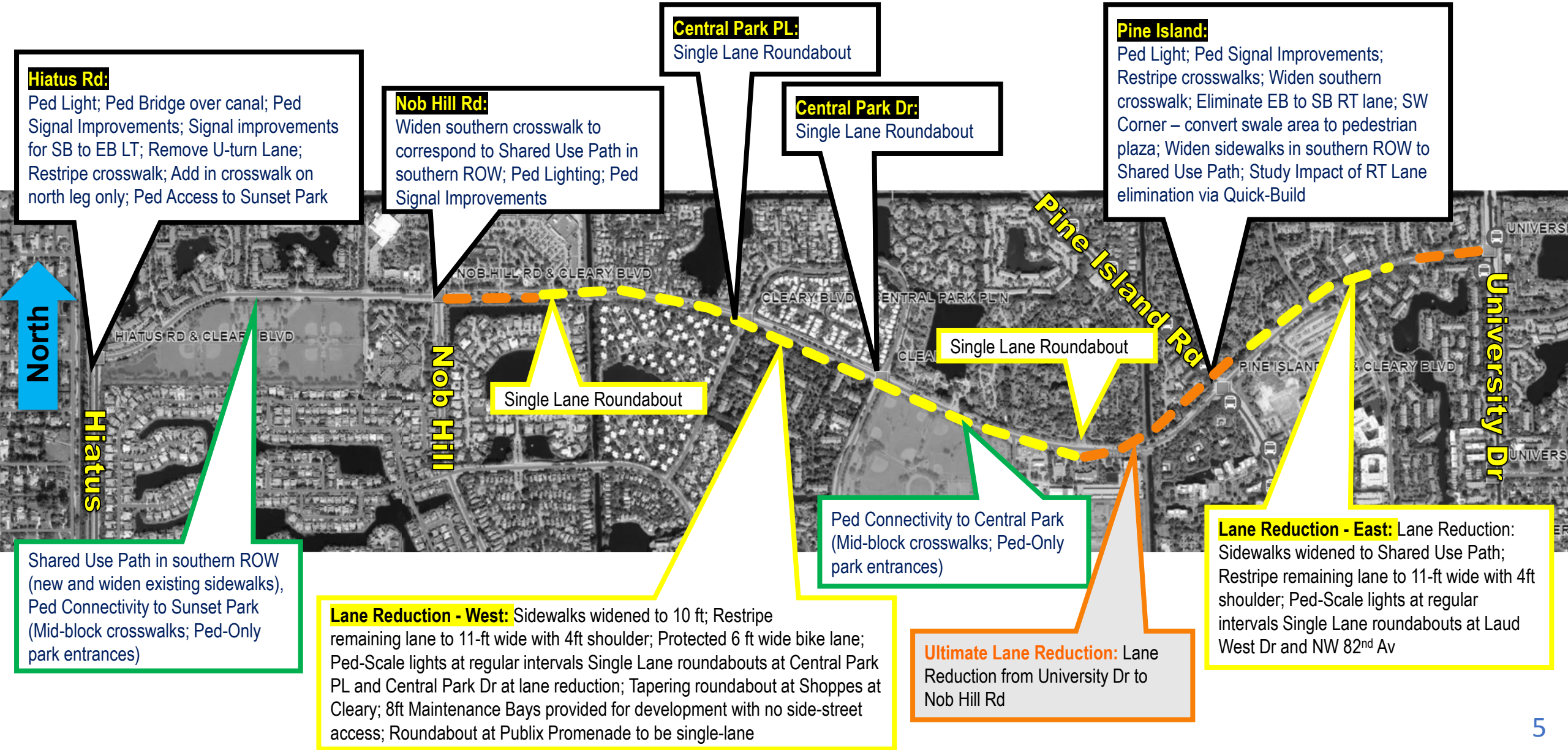

**Hiatus Rd:**  
 Ped Light; Ped Bridge over canal; Ped Signal Improvements; Signal improvements for SB to EB LT; Remove U-turn Lane; Restripe crosswalk; Add in crosswalk on north leg only; Ped Access to Sunset Park

**Nob Hill Rd:**  
 Widen southern crosswalk to correspond to Shared Use Path in southern ROW; Ped Lighting; Ped Signal Improvements

**Central Park PL:**  
 Single Lane Roundabout

**Central Park Dr:**  
 Single Lane Roundabout

**Pine Island:**  
 Ped Light; Ped Signal Improvements; Restripe crosswalks; Widen southern crosswalk; Eliminate EB to SB RT lane; SW Corner – convert swale area to pedestrian plaza; Widen sidewalks in southern ROW to Shared Use Path; Study Impact of RT Lane elimination via Quick-Build

Shared Use Path in southern ROW (new and widen existing sidewalks), Ped Connectivity to Sunset Park (Mid-block crosswalks; Ped-Only park entrances)

**Lane Reduction - West:** Sidewalks widened to 10 ft; Restripe remaining lane to 11-ft wide with 4ft shoulder; Protected 6 ft wide bike lane; Ped-Scale lights at regular intervals Single Lane roundabouts at Central Park PL and Central Park Dr at lane reduction; Tapering roundabout at Shoppes at Cleary; 8ft Maintenance Bays provided for development with no side-street access; Roundabout at Publix Promenade to be single-lane

Ped Connectivity to Central Park (Mid-block crosswalks; Ped-Only park entrances)

**Ultimate Lane Reduction:** Lane Reduction from University Dr to Nob Hill Rd

**Lane Reduction - East:** Lane Reduction: Sidewalks widened to Shared Use Path; Restripe remaining lane to 11-ft wide with 4ft shoulder; Ped-Scale lights at regular intervals Single Lane roundabouts at Laud West Dr and NW 82<sup>nd</sup> Av

# University Dr @ Broward Blvd

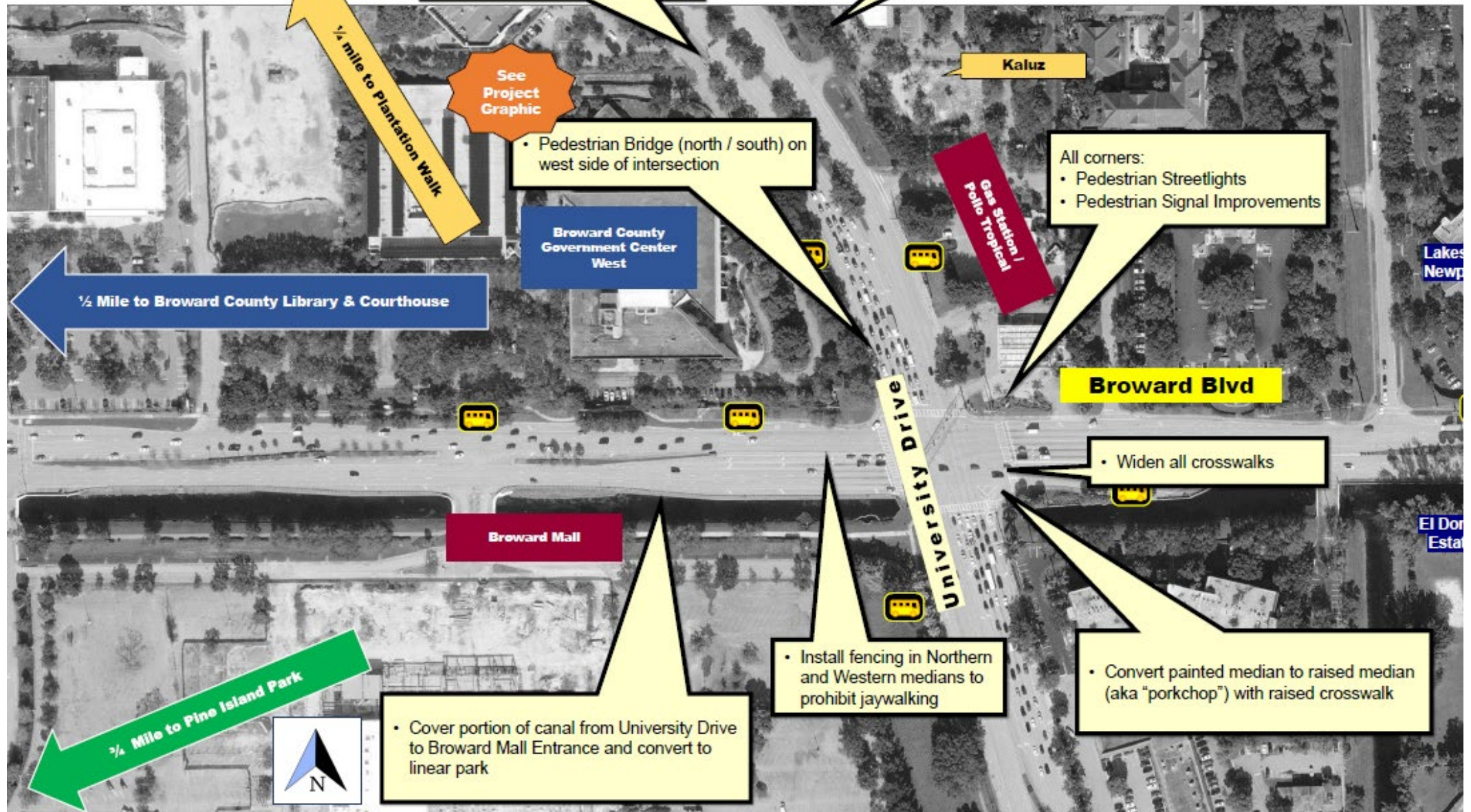

# University Dr @ Broward Blvd

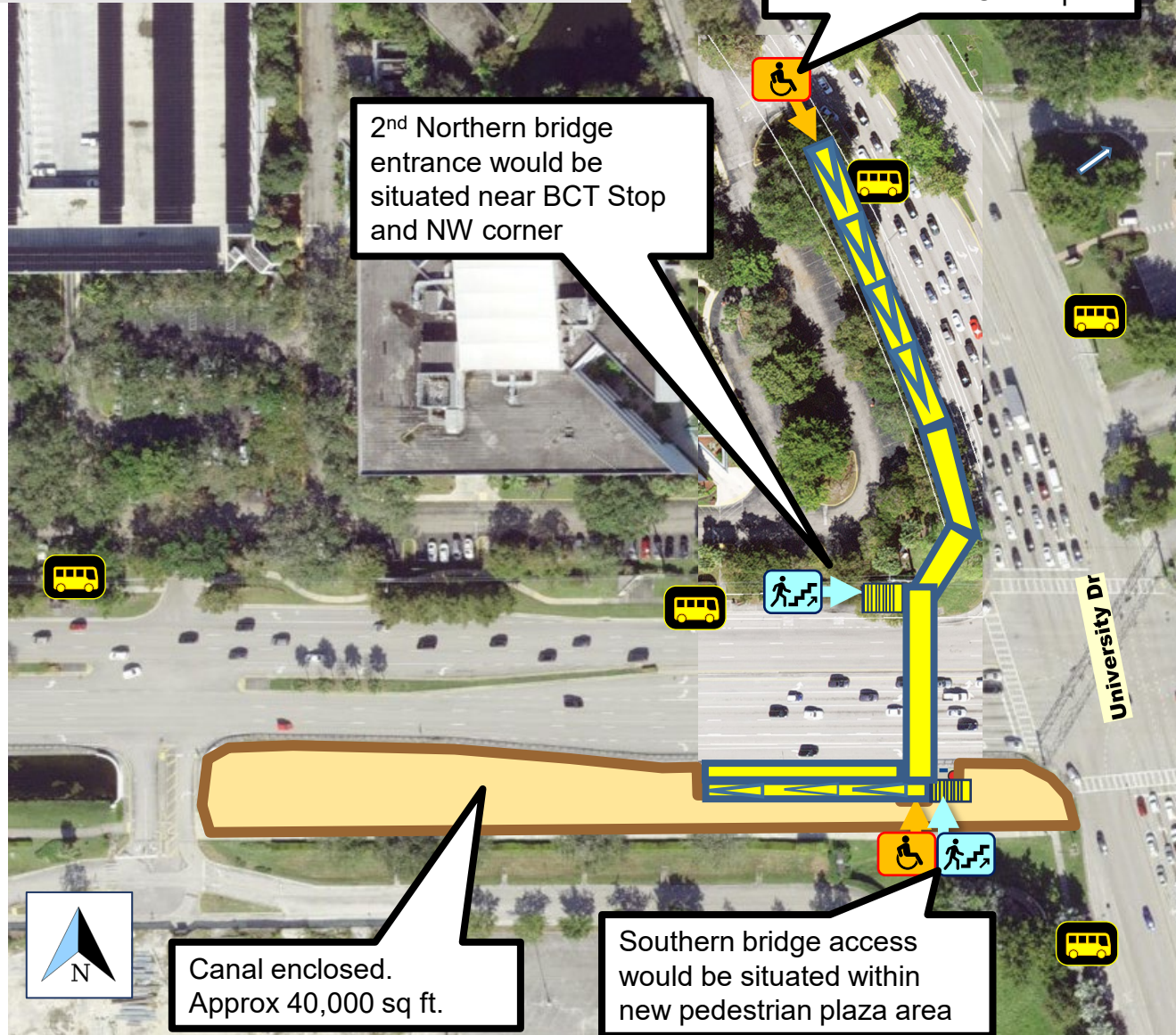

## Pedestrian Bridge Examples



## Canal Conversion Best Practice: Coral Springs ArtWalk



# University Dr @ Broward Blvd





# University Dr @ Broward Blvd



# Cleary Bl @ Pine Island Rd

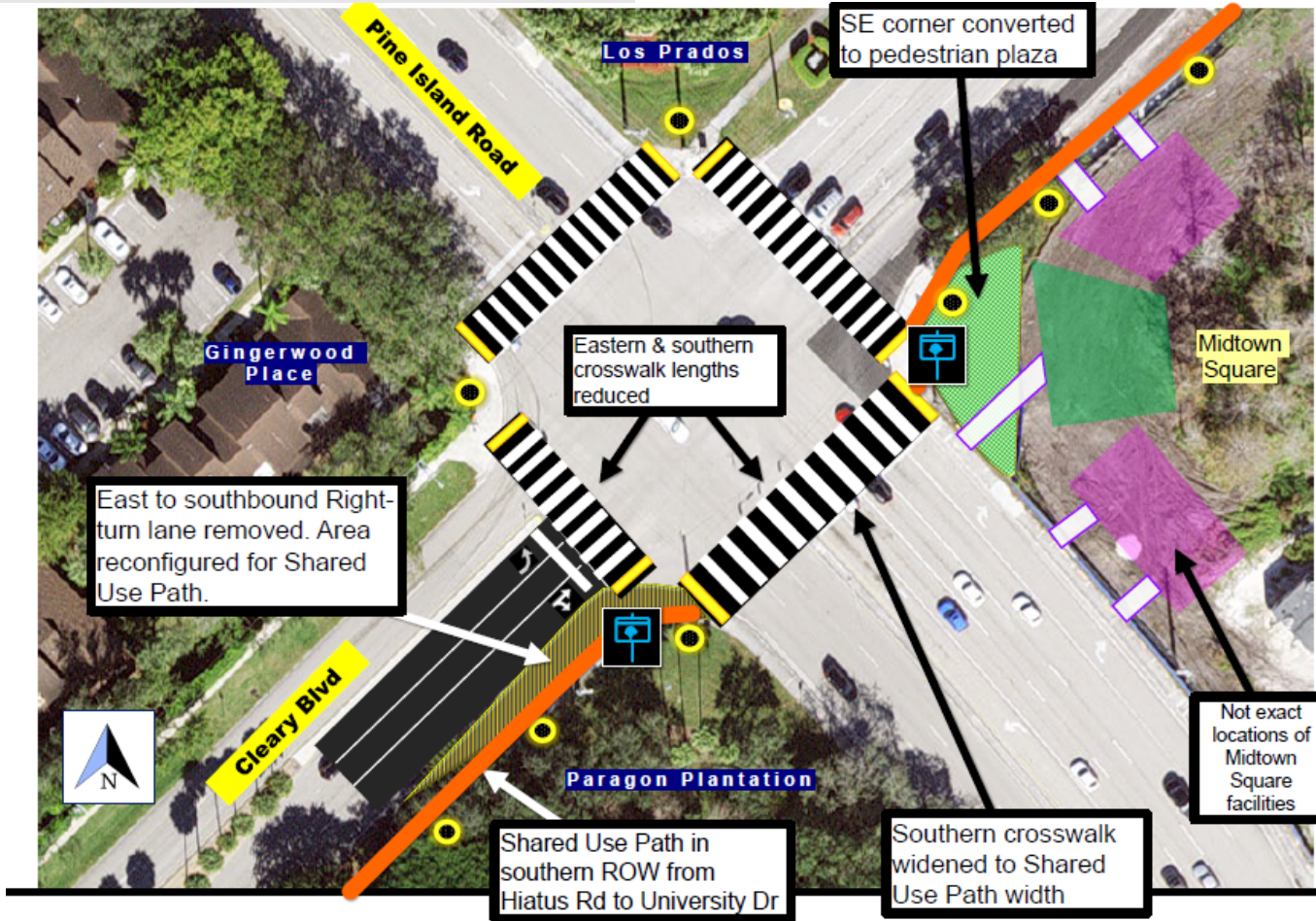

## Legend

- Existing Sidewalk reconfigured to Shared Use Path
- Crosswalk with High Visibility Pavement Markings
- Pedestrian Street Lights
- Lane Removal for Shared Use Pat
- New Pedestrian Plaza
- Wayfinding Signage
- Future Midtown Square Restaurant
- Future Midtown Square Plaza
- Future Midtown Square Sidewalks

## Recommendation Examples

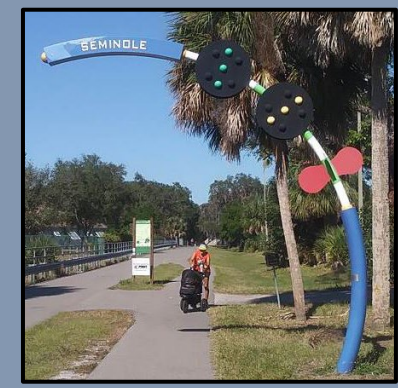
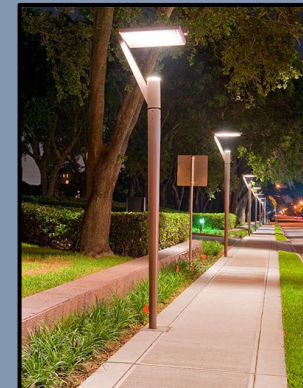

# Cleary BI @ Pine Island Rd



# Cleary Blvd @ Midtown North

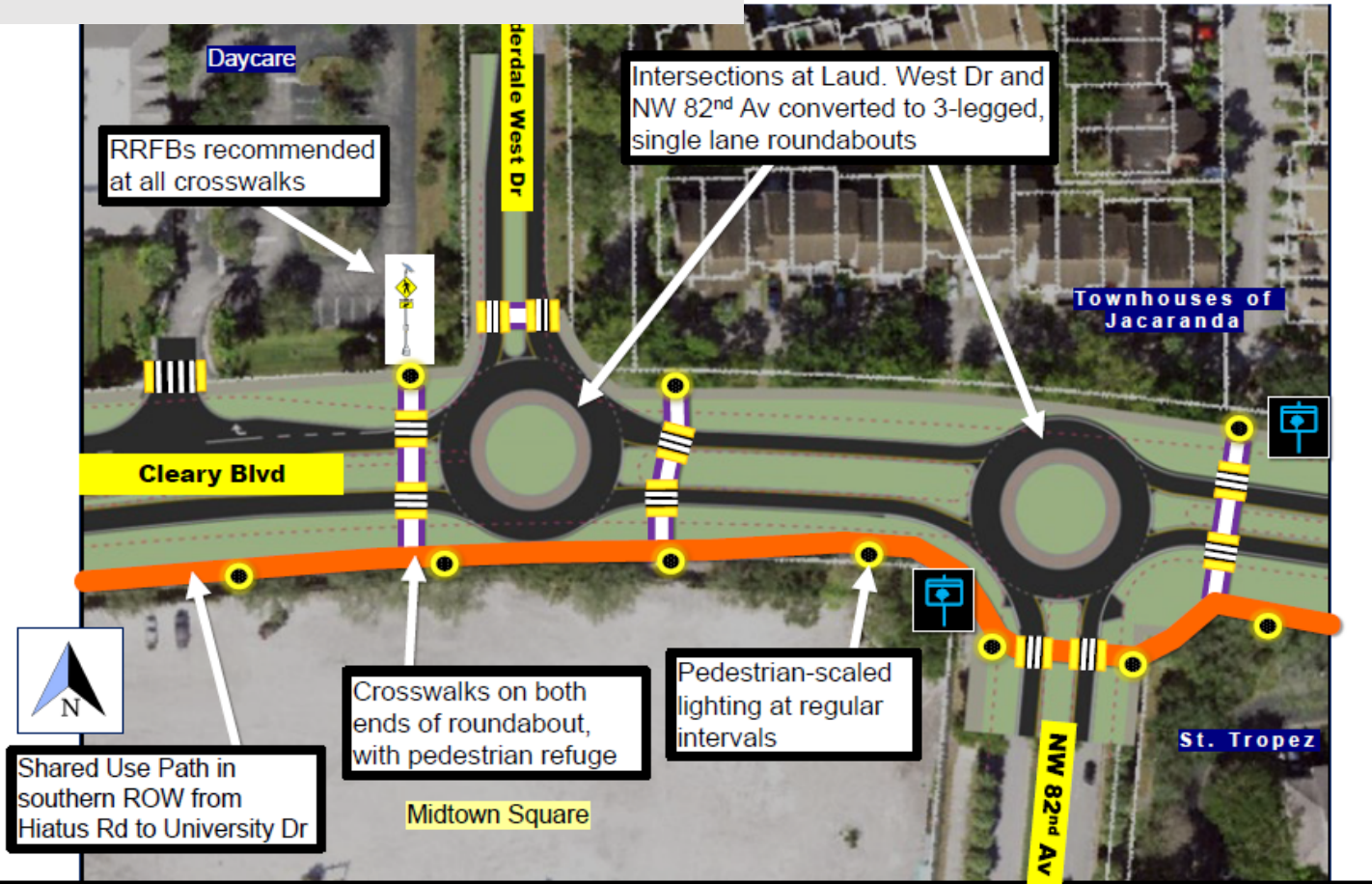

Shared Use Path in southern ROW from Hiatus Rd to University Dr

- Legend**
- Existing Sidewalk reconfigured to Shared Use Path
  - Crosswalk with High Visibility Pavement Markings
  - Pedestrian Street Lights
  - Rectangular Rapid Flashing Beacon (RRFB)
  - Wayfinding Signage
  - Pedestrian Path and Midblock Crosswalk
  - Existing Curb Line
  - Property Line

## Recommendation Examples

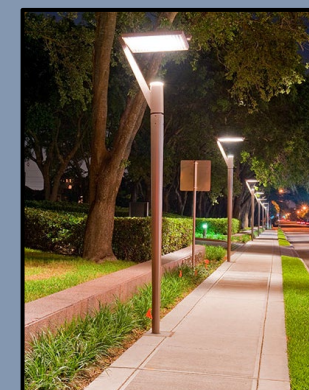
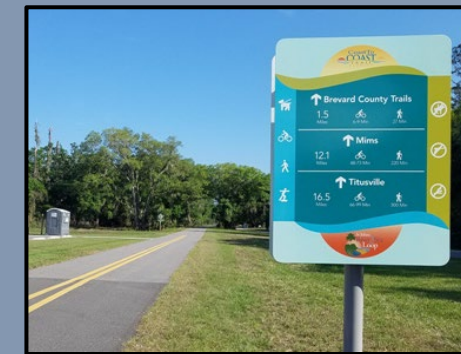

# MMTP Phase 2: Public Engagement

Event	Date	Time	Description
Rock the Park @ Central Park	Feb 3	6 pm	MMTP General Outreach
City Hall – Community Mtg	Feb 28	6 pm	University Dr Projects
Central Park - Community Mtg	Mar 14	6 pm	Cleary Blvd & Nob Hill Rd Projects
Midtown Adv Board	Mar 16	11 am	MMTP Presentation
P&Z Board Mtg	April 11	6 pm	MMTP Presentation
Gateway Adv Board	Apr 19	11 am	MMTP Presentation
Park East HOA Mtg	Apr TBD	6 pm	NW 46 <sup>th</sup> & NW 5 <sup>th</sup> Projects
City Council Workshop	May 10	6 pm	MMTP Presentation



THE CITY OF PLANTATION  
MULTIMODAL MASTER TRANSPORTATION PLAN



**JOIN US** to learn more and share your thoughts about proposed improvements to sidewalks, bike paths, and roadways in your community.



**STAY INFORMED**

Learn more about the Multimodal Master Transportation Plan, sign up for updates, and leave a comment.

**Visit:**  
[BrowardMPO.org/city-of-plantation](http://BrowardMPO.org/city-of-plantation)



COMMUNITY MEETINGS

Presentation Starts at 6:00PM

**Improvements for University Dr.**  
City Hall  
Tuesday, February 28, 2023  
400 NW 73 Ave

**Improvements for Cleary Blvd. and Nob Hill Rd.**  
Central Park  
Multi-Purpose Building  
Tuesday, March 14, 2023  
9151 NW 2 St

For more information on Community Meetings or other planned events please Contact [AskCityHall@Plantation.org](mailto:AskCityHall@Plantation.org)

**PUBLIC INPUT OPPORTUNITY: MULTIMODAL MASTER TRANSPORTATION PLAN**

**YOU'RE INVITED**

**WHEN & WHERE**  
Friday, February 3, 2023 at 6:00pm  
Central Park 600 Central Park Drive

**VISIT THE BOOTH AT ROCK THE PARK. SHARE YOUR IDEAS!**

## Broward MPO City Services Staff Participates in Plantation's Rock the Park Event



Since August 2022, BMPO City Services Staff have been providing technical assistance to the City of Plantation for the development of a citywide Multimodal Master Transportation Plan (MMTP). On February 3, MPO staff attended the City of Plantation's Rock The Park event to promote upcoming community meetings for the recommended safety and multimodal improvements to University Drive, Cleary Blvd, and Nob Hill Road. For more information on the Plantation MMTP or the Community Meetings please click [HERE](#).



The City of Plantation  
**MULTIMODAL MASTER TRANSPORTATION PLAN**

Share YOUR Comments

[www.surveymonkey.com/r/MMTP-PublicComment](http://www.surveymonkey.com/r/MMTP-PublicComment)











Move People & Goods | Create Jobs | Strengthen Communities

# City of Plantation

## Multimodal Master Transportation Plan: Phase 2

Plantation Midtown Advisory Board Meeting

March 16, 2023